

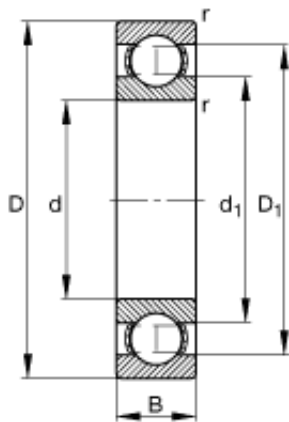

BEARING Driveshaft USA CORP.



50 mm x 110 mm x 27 mm fag 6310 bearing

Bearing No. 6310

6310 Bearing 2D drawings and 3D CAD models

| | |
|--------------------|--|
| Size | 50x110x27 mm |
| Bore Diameter | 50 mm |
| Outer Diameter | 110 mm |
| Width | 27 mm |
| d | 50 mm |
| D | 110 mm |
| B | 27 mm |
| D ₁ | 91,6 mm |
| D _{a max} | 99 mm |
| d ₁ | 68,3 mm |
| d _{a min} | 61 mm |
| r _{a max} | 2 mm |
| r _{min} | 2 mm |
| m | 1,1 kg / Weight |
| C _r | 68000 N / Dynamic load rating (radial) |
| C _{0r} | 38500 N / Static load rating (radial) |
| n _G | 9500 1/min / Limiting speed |
| n _B | 7700 1/min / Reference speed |
| C _{ur} | 2600 N / Fatigue limit load, radial |